

YARRA PRO SWITCH FIRE RATED DOWNLIGHT

Product Code: HSYPFRD

Input Voltage: 230V

Version: 1.0

Ambient Temp: -10°C~40°C

Date: November 2024

MAIN FEATURES

- ✓ 30/60/90 MIN FIRE RATED
- ✓ IP65
- ✓ FAST FIX LENNEL WIRING BOX
- ✓ 3 WATTAGE/4CCTK SWITCH
- ✓ FIXED AND TILT BEZEL OPTIONS



SAFETY INFORMATION

INSTALLATION MUST BE PERFORMED BY A QUALIFIED ELECTRICIAN AND IN FULL COMPLIANCE WITH BS7671 REGULATIONS.

Before conducting an insulation resistance test, ensure the light fitting is disconnected to prevent damage or interference.



INSTALLATION INSTRUCTIONS

1. Ensure the power supply is switched off before beginning the installation process.
2. Choose a suitable mounting location, making sure to check for hidden cables, water pipes, ceiling or any other obstructions in the selected area.
3. Cut a 68mm diameter hole in the ceiling.
4. SWITCH to required CCTk and wattage settings on the Wiring Box (2200k and 4watt are standard settings).
5. Fit Bezel (Supplied seperately) to the Downlight.
6. Make Electrical connections, observing polarity. Fast Fix connections provided for Loop-In/Loop-out wiring.
7. Close then connect the two parts of the Wiring box together.
8. Feed wiring box through the hole cut in the ceiling.
9. Fold the springs upwards and through the ceiling hole, Yarra Pro SWITCH will then snap into position.
10. Turn on power and test to confirm correct operation. If using Dimmer, check rating/setting of dimmer.

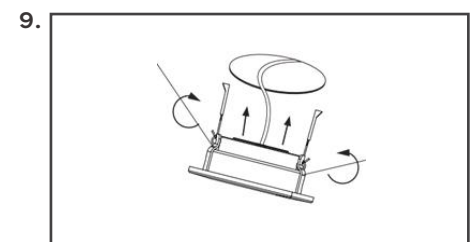
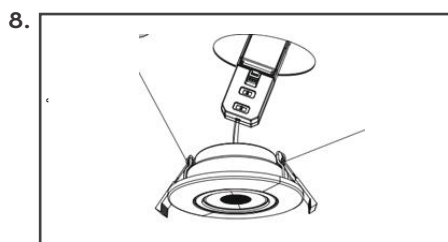
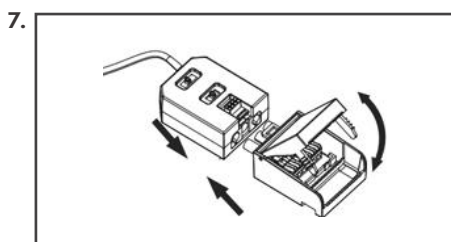
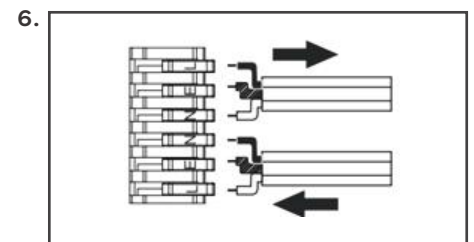
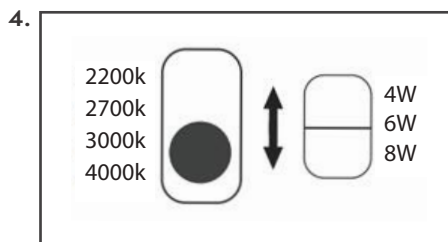
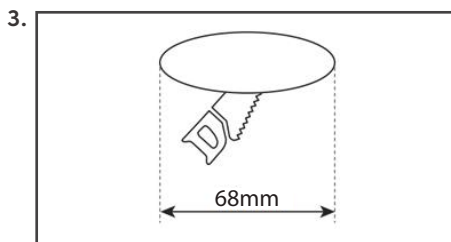

Warranty Disclaimer - Please note that all lighting equipment must be used in accordance with the instructions provided in this document. Failure to follow these instructions, including but not limited to improper installation, positioning, control, or use of non-recommended accessories, will invalidate the equipment warranty. Always ensure proper safety protocols and the use of certified technicians for setup and operation. ON SITE WARRANTY SUBJECT TO CONDITIONS AND UK REGIONS ONLY*