

FOSS SWITCH FLOODLIGHT

Product Code: HSSLFO10, HSSLFO20, HSSLFO30

Input Voltage: 230V

Version: 1.0

Ambient Temp: -10°C~40°C

Date: September 2024



MAIN FEATURES

- ✓ CCTK SWITCH
- ✓ PLUG IN SENSOR
- ✓ PRE-WIRED
- ✓ ADJUSTABLE BRACKET
- ✓ FAST FIX
- ✓ 90Lm/W

SAFETY INFORMATION

INSTALLATION MUST BE PERFORMED BY A QUALIFIED ELECTRICIAN AND IN FULL COMPLIANCE WITH BS7671 REGULATIONS.

Before conducting an insulation resistance test, ensure the light fitting is disconnected to prevent damage or interference.



INSTALLATION INSTRUCTIONS

1. Ensure the power supply is switched off before beginning the installation process.
2. Choose a suitable mounting location, making sure to check for hidden cables, water pipes, or any other obstructions in the selected area.
3. Mark the positions for the mounting bracket holes, and drill the appropriate 6mm holes in the surface, ensuring alignment with the bracket.
4. Secure the mounting bracket to the surface using the appropriate screws or anchors.
5. Connect wires as follows: Live (Brown), Earth (Green/Yellow), Neutral (Blue). Use an IP-rated connector box for outdoor installations.
6. Remove the rubber cover and use the SWITCH selector to choose 3000K, 4000K, or 6000K (default is 3000K). Replace the cover to maintain the IP rating.
7. Adjust the aim of the Foss SWITCH Floodlight to achieve the desired lighting angle.
8. Restore power and test the installation to confirm correct operation.

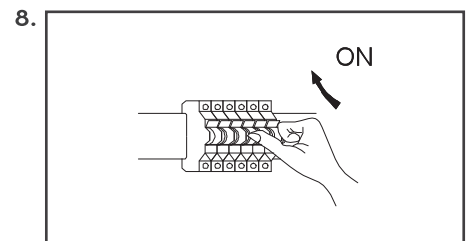
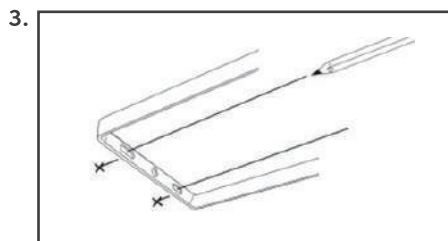
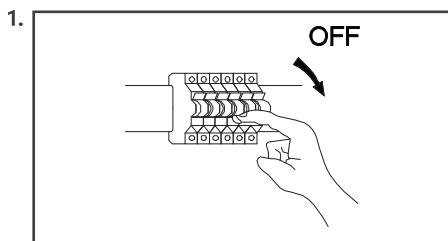

Failure to adhere to these instructions will result in the warranty being voided.

FOSS SWITCH FLOODLIGHT

Product Code: HSSLFO10

Input Voltage: 230V

Version: 1.0

Ambient Temp: -10°C~40°C

Date: September 2024

OPTIONAL PIR SENSOR ACCESSORY WITH OVERRIDE FUNCTION

Override allows the sensor to operate as Photocell and floodlight will remain on during low ambient natural light, Dusk-to-Dawn.

INSTALLATION INSTRUCTIONS

1. Ensure the power supply is switched off before beginning the installation process.
2. Remove the screw cap from the base of the Foss SWITCH Floodlight.
3. Securely attach the sensor to the socket. Then restore power.
4. Adjust sensor settings:
Ambient Light: 10~2000 lux (triggers in low light) Time: 0 sec to 7 min (floodlight duration) Detection Range: 2M to 12M (max distance)
5. The sensor features a 160° detection range.
6. To activate the override function, turn the power ON, then toggle OFF/ON twice. The floodlight will pulse to confirm activation, keeping it illuminated during low light conditions with photocell control. Turning power OFF resets this function.
7. The sensor can be aimed independently, but ensure it's positioned away from direct or reflected light to avoid interference with its operation.

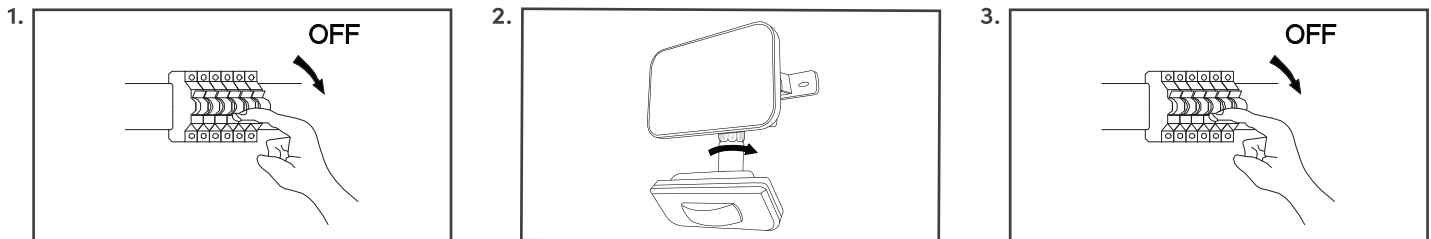

*Warranty Disclaimer - Please note that all lighting equipment must be used in accordance with the instructions provided in this document. Failure to follow these instructions, including but not limited to improper installation, positioning, control, or use of non-recommended accessories, will invalidate the equipment warranty. Always ensure proper safety protocols and the use of certified technicians for setup and operation. * ON SITE WARRANTY SUBJECT TO CONDITIONS AND UK REGIONS ONLY*