

QUICK START GUIDE

NOTE – PLEASE ONLY FOLLOW THESE INSTRUCTIONS IF YOU ARE USING THE ALARMS WITHOUT THE OPTIONAL CONTROL UNIT. IF YOU ARE USING THE CONTROL UNIT IN THE SYSTEM, FOLLOW THE QUICK START GUIDE THAT CAME WITH THAT INSTEAD.

DO THIS BEFORE YOU INSTALL ANY OF THE DEVICES!

1. Turn on all alarms to be installed in the system by sliding them onto their baseplates until they click into place.

2. On the **first alarm** (doesn't matter which) hold down the small rectangular pairing button on the side of the alarm baseplate **until the red LED lights up and stays on** (It stays on for two minutes).

3. Take one of your other alarms and press the small rectangular pairing button on the side of the alarm baseplate **TWICE**. A red LED next to this button will flash five times. This alarm is now in the Home Group. Place this alarm **to your left**.

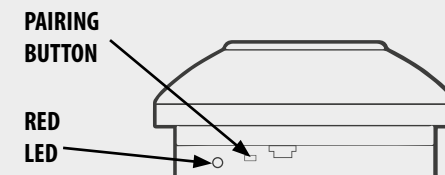

HISPEC RF-PRO ALARMS

Please read through all of the steps thoroughly before installation. It is essential to pair all of the alarms in the system, to ensure they will not communicate with any other nearby systems. Failure to pair the system will prevent it from operating correctly.

4. Making sure the red LED is still lit on the **first alarm**, repeat Step 3 for each of the alarms. If the red LED on the first alarm (directly in front of you) goes out, repeat Step 2 for that alarm. Then continue with Step 3 for the remaining alarms to your right.

5. All of the alarms are now paired – you can check this by **holding the TEST button** down on any alarm until they have all sounded. This may take up to **20 seconds**.

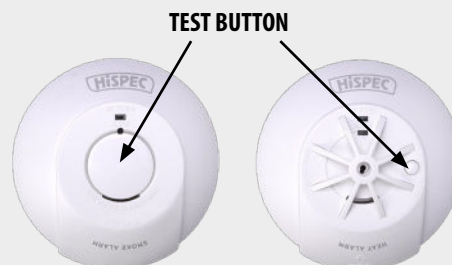

6. You can now remove them from the baseplate by pressing the release tab and sliding the alarm head off (they will stay paired) and install them.

When installed, repeat Step 5 to test.

HISPEC

LIGHTING • FIRE & CO DETECTION

For details on individual alarm devices, consult the instruction manuals enclosed with them.

RFPRO

QUICK START GUIDE FOR HISPEC RF MAINS DETECTORS HSSA/HE/RF10-PRO, HSSA/PE/RF10-PRO, HSSA/HCO/RF10-PRO, HSSA/PH/RF10-PRO, HSSA/CO/RF10-PRO