



INTERCONNECTABLE FAST FIX MAINS SMOKE DETECTOR

**FAST
FIX**



FEATURES

- Interconnect up to 20 wired detectors over 80m max
- 9v Battery Backup included
- Loud 85dB alarm
- Fast Fix base included
- Insect proof
- Test function and hush feature

TECHNICAL INFORMATION

Scheme Rating:	D2
Detection Type:	Photoelectric Sensor
Power Source:	220-240v
Battery Backup:	9v Battery Backup
Alarm Sound Level:	85dB at 3 metres
Operating Temp:	0°C ~ 40°C
Operating Current:	<40mA operation
Coverage Area:	60m ² max at 2.4m mounting height
Weight:	162g
Approvals:	BS EN14604:2005

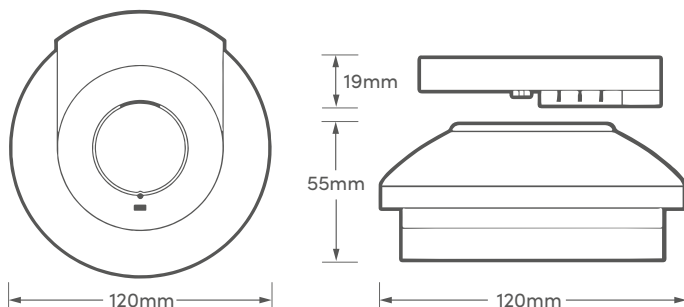

Product Code: HSSA/PE/FF