

## MAIN FEATURES

- ✓ 4 WATTAGE ADJUSTABLE - 8W, 11W, 13W & 16W
- ✓ 3 CCT
- ✓ HINGED GEAR TRAY
- ✓ TOOL FREE INSTALLATION FOR MODULES
- ✓ SPIRIT LEVEL INCLUDED
- ✓ CHANGEABLE BEZEL
- ✓ PUSH FIT CONNECTOR
- ✓ ANTI TAMER PROOF - T 15 INCLUDED
- ✓ PLUG AND PLAY ACCESSORIES

## SAFETY INFORMATION

This luminaire must be installed and operated in full accordance with the information contained in this document. Failure to do so will invalidate any warranty.

**INSTALLATION MUST BE CARRIED OUT BY A QUALIFIED PROFESSIONAL AND FOLLOW RELEVANT SAFETY STANDARDS, WIRING AND BUILDING REGULATIONS.**

### WARNING

Switch off power before installation!

Switch the power supply back on after installation & circuit examination. Professional electricians are required for installation & maintenance.



## INSTALLATION INSTRUCTIONS

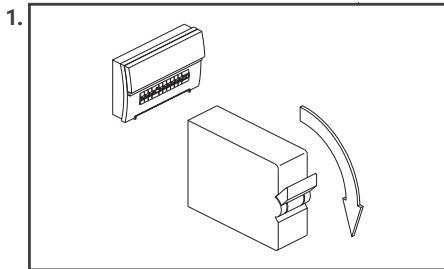

Always switch off the mains supply before installation or servicing.

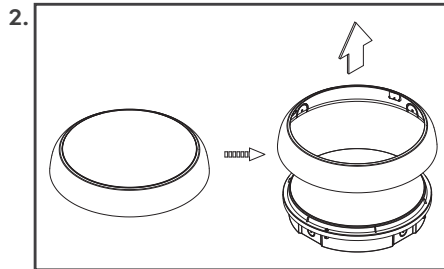

Remove bezel.

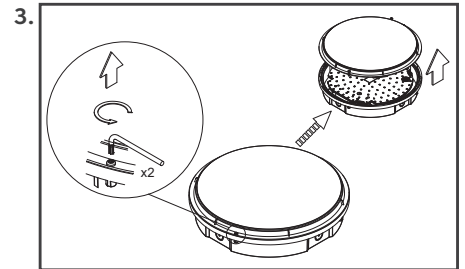

Remove diffuser security screws, providing the tools provided and rotate the diffuser to unlock and rotate the diffuser to unlock and remove.

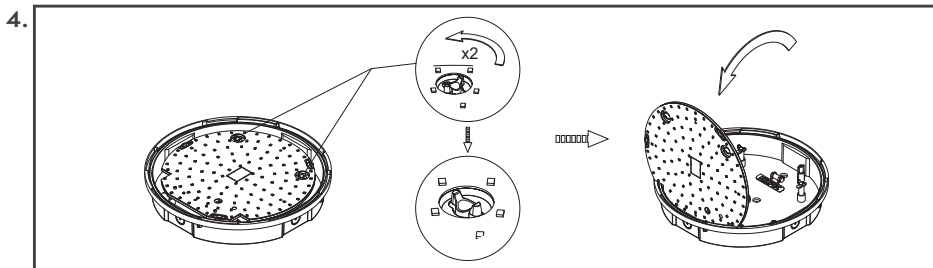

Rotate locking lugs and allow the gear tray to hinge open.

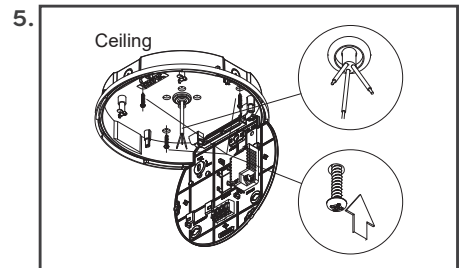

Feed the mains cable through the grommet and fix in position with x3 screws.

## PACIFIC SWITCH PRO LED CIRCULAR BULKHEAD DECORATIVE FITTING 16 WATTAGE MAX

Product Code: HSLEDDF

Ambient Temp: -20°C~40°C

Voltage: 220-240V - 50/60Hz

Date: November 2025

Version: 1

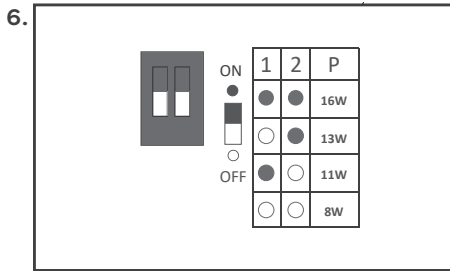

Adjust wattage settings using the dip switch on the driver.

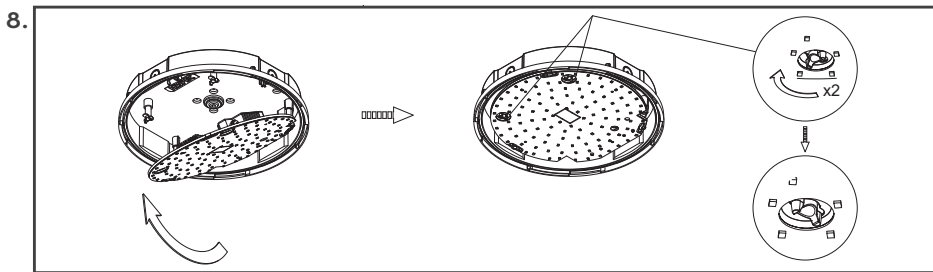
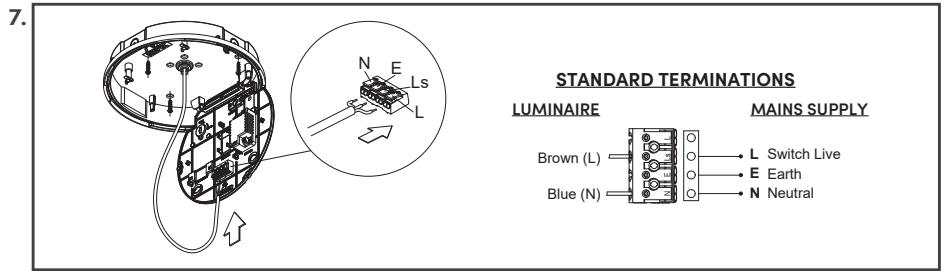

Refit the gear tray and locking position.

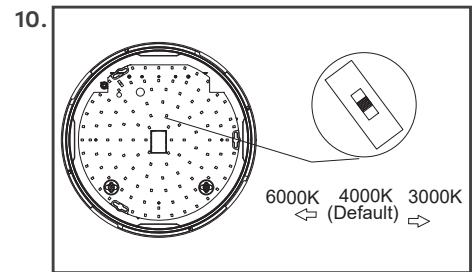

Adjust colour temperature.

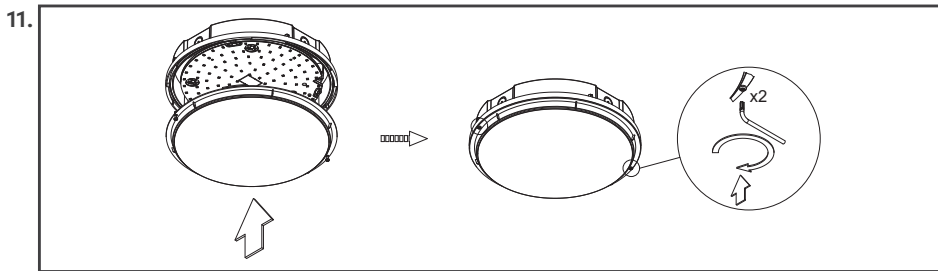

Refit diffuser and secure retaining screws provided.

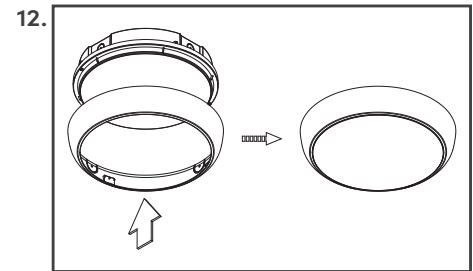

Refit bezel.

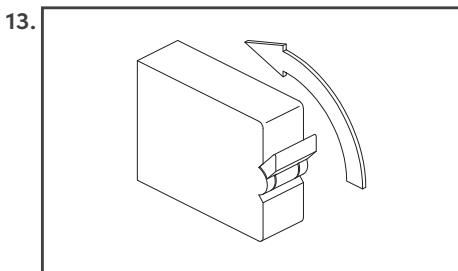

Switch on the mains supply after installation or servicing.

## MICROWAVE MODULE INSTRUCTIONS

1.

I - 100%  
II - 50%



	1	
I	●	100%
II	○	50%

### Sensitivity

Sensitivity can be adjusted by selecting the combination on the DIP switches for different applications.

2.

I - 5s  
II - 90s  
III - 180S  
IV - 10min



	2	3	
I	●	●	5s
II	●	○	90s
III	○	○	180s
IV	○	●	10min

### Hold Time

Hold time refers to the time period that the light remains 100% on if no more movement is detected.

3.

I - Disable  
II - 10Lux



	4	
I	●	Disable
II	○	10lux

### Daylight threshold

Different daylight thresholds can be preset on DIP switches. Light will always turn on upon movement if the daylight sensor is disabled.

4.

I - 0s  
II - 10s  
III - 10min  
IV - +∞



	5	6	
I	●	●	0s
II	●	○	10s
III	○	●	10min
IV	○	○	+∞

### Standby time

This is the time period that the light remains at a low level before it is completely turned off.

5.

I - 10%  
II - 30%



	7	
I	●	10%
II	○	30%

### Standby dimming level

Light can be dimmed to different levels after a hold time.

## EMERGENCY PACK INSTRUCTIONS

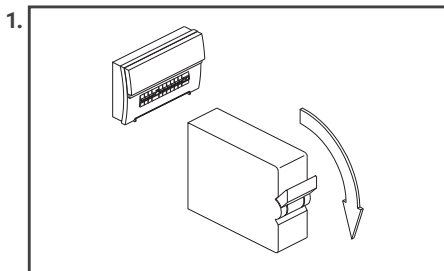

Always switch off the mains supply before installation or servicing.

2.

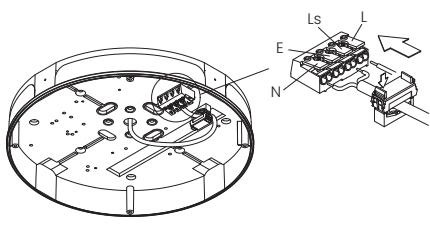

**EMERGENCY TERMINATIONS**

LUMINAIRE	MAINS SUPPLY
Black (L)	UNSWITCHED SUPPLY
Brown (Ls)	SWITCHED SUPPLY
Blue (N)	NEUTRAL

For continuity of termination of CPC

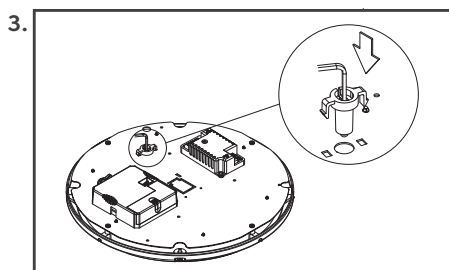

Insert the indicator into the gear tray.

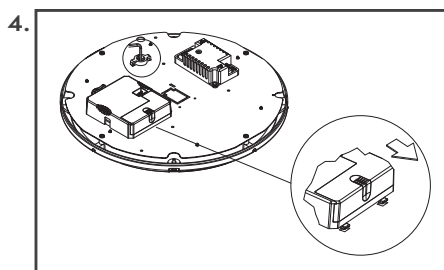

Insert the emergency pack into the gear tray.

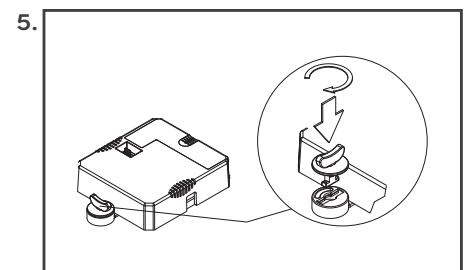

Fix the other end.

## PACIFIC SWITCH PRO LED CIRCULAR BULKHEAD DECORATIVE FITTING 16 WATTAGE MAX

Product Code: HSLEDDF

Ambient Temp: -20°C~40°C

Voltage: 220-240V - 50/60Hz

Date: November 2025

Version: 1

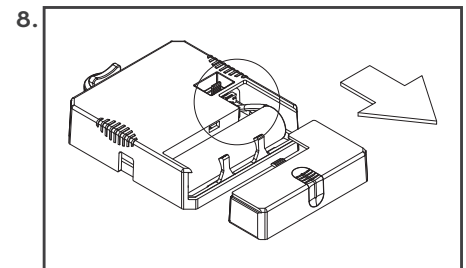
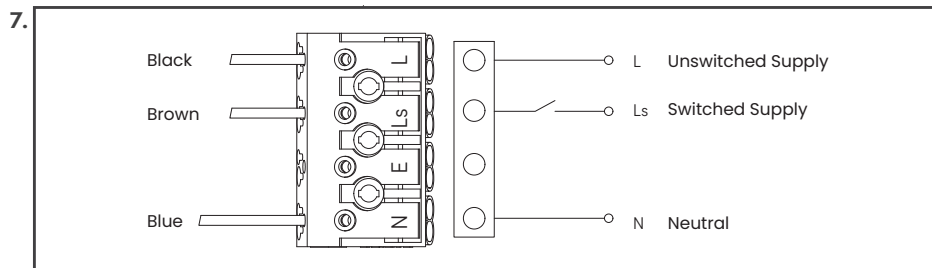
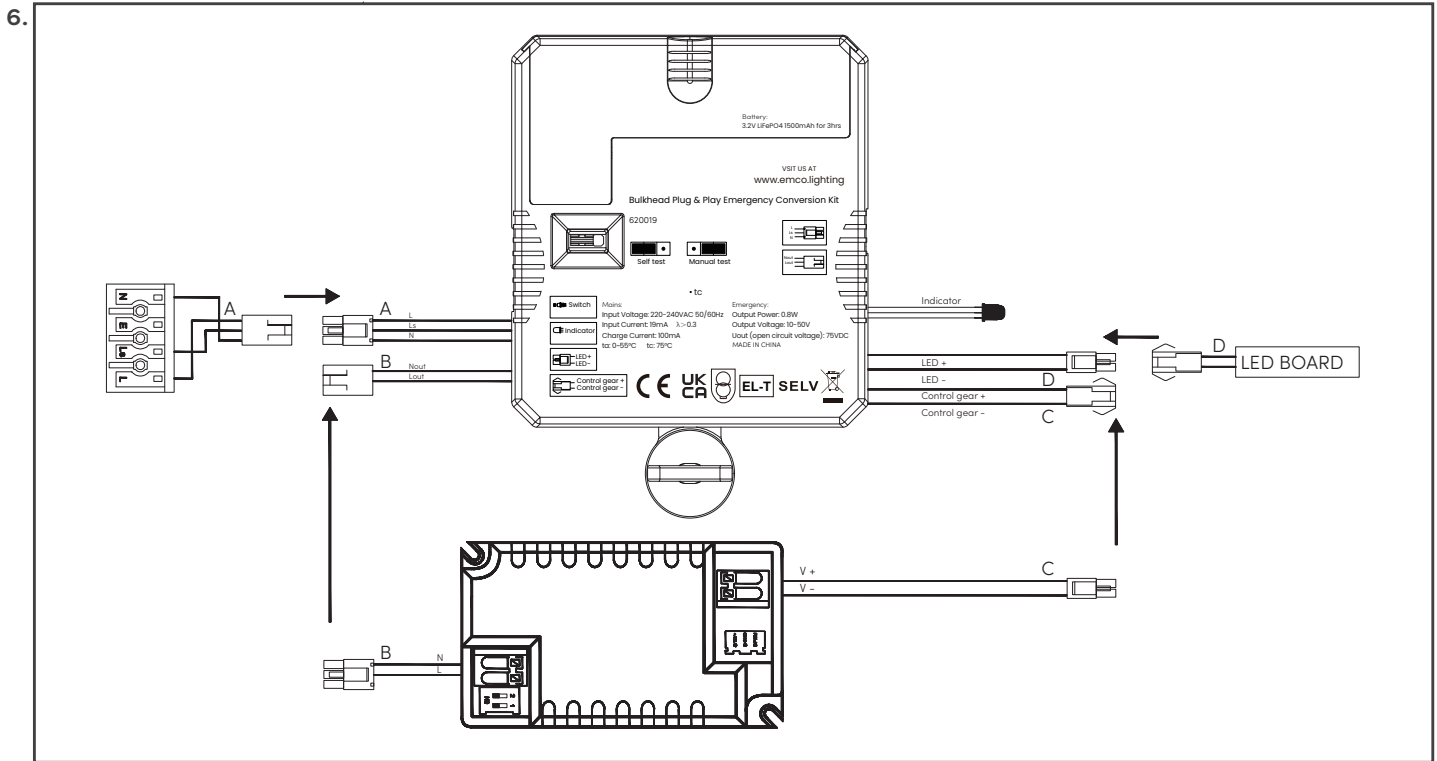

Slide battery cover off.

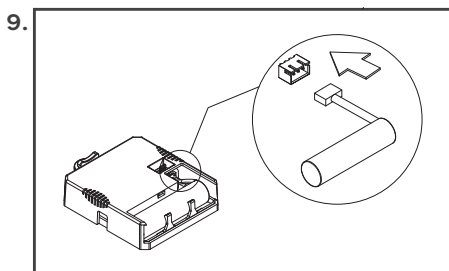

Connect the battery to the emergency pack.

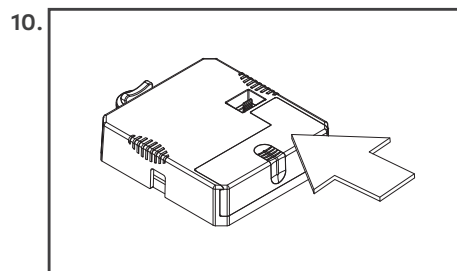

Slide battery cover back on.

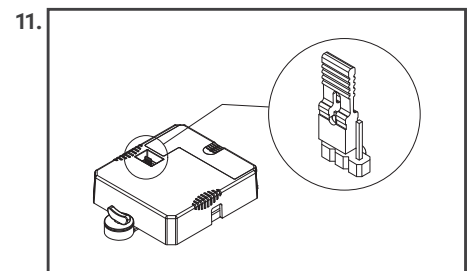

Manual test. See point 12 for manual test option.

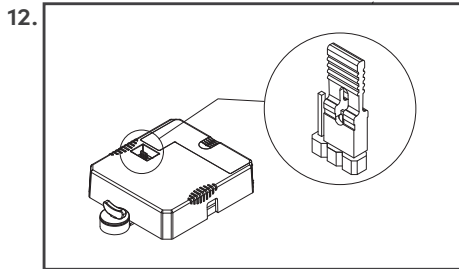

Default Setting: Manual test (Self test)

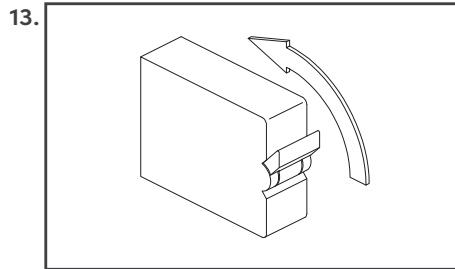

Switch on the mains supply after installation or servicing.

## ECODESIGN & CIRCULAR ECONOMY (TM66)

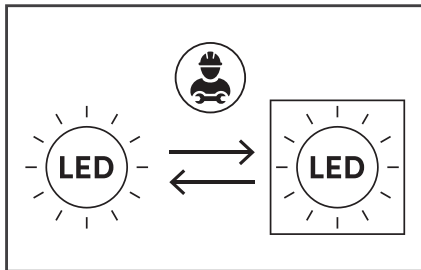

Replaceable ( LED only) light source by a professional

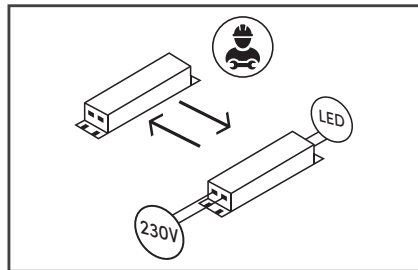

Replaceable control gear by a professional

## SPECIFICATIONS FOR SELF TEST

### Function Test

The function test is carried out every week for 5 seconds. It will check the connection of the battery, battery discharging and the connection of the LED module.

### Duration Test

An initial duration test is automatically carried out at first power on, but after 24 hours of charging. After that, the duration test is carried out for 3 hours every half year, on one day within the 175th day to the 195th day. It will also check the connection of the battery and the LED module.

Descriptions corresponding to the color and status of the charge indicator.

Charge Indicator Colour	Status	On Time (Seconds)	Off Time (Seconds)	Description	
Green		Permanent on	/	/	Normal status when mains connected
		Slow flash	1s	1s	Duration test running
		Fast flash	0.2s	0.2s	Function test running
		Normal flash three times only	0.5s	0.5s	Time reset
Red		Permanent on	/	/	Battery connection is abnormal or failure
		Slow flash	1s	1s	Lamp connection is abnormal or failure
		Fast flash	0.2s	0.2s	Duration failure - the capacity of the battery is decay
Light Off		Off	/	/	Emergency mode

It should be taken to check connectivity or replace the abnormal battery or lamp. Test button for manual inspection on the function test or duration test.

## Mode of operation

Duration	Function
Press for <2s	Simulate emergency mode
Press for 3-5s	Start duration test manually. The test can be aborted by pressing off (1-2s).
Press for 5-8s	Start Function test manually for 60s. The test can be aborted by pressing off (1-2s). *Must be conducted when the initial duration test finished and after another 24 hours battery charging
Press for >10s	Time Reset

## Note:

1. When the mains is on, the green indicator will be permanently on. It will check the connection of the battery and the connection of the LED module. When the mains is off, no test will be performed.
2. When there is a lamp failure at non-maintained mode, the indicator remains green but will turn red and be slow flashing after the failure is detected in a weekly function test.
3. The luminaries on which we want to perform the duration tests must be connected to the mains supply for at least 24 uninterrupted hours.
4. When the fault is corrected, the indicator will only be reset to its normal status after the mains are reconnected or the test switch is pressed.
5. The accuracy of the timing of the test interval is ensured it an accuracy of  $\pm 75$  s per week. The timing function will be retained through periods of mains supply failure or interruption for up to 7 days.
6. The battery charge shall not start if the cell temperature is below 0°C or above 65°C.

## LIMITED PRODUCT WARRANTY

This device is under warranty under normal use and service for a period of 3 years from the date of purchase. The company will not be obligated to repair or replace parts which are found to be in need of repair because of misuse, damage or alterations that have occurred after the date of purchase. Send the product with proof of purchase, postage and return postage prepaid, to your local distributor. The liability of the company arising from the sale of this product shall not in any case exceed the cost of replacement of the product and in no case shall the company be liable for consequential loss or damages resulting from the failure of the product.

HISPEC ELECTRICAL PRODUCTS LTD. SHALL HAVE NO LIABILITY FOR ANY PERSONAL INJURY OR PROPERTY DAMAGE, OR ANY SPECIAL, INCIDENTAL, CONTINGENT OR CONSEQUENTIAL DAMAGE OF ANY KIND, RESULTING FROM A DEFECTIVE PRODUCT. THE EXCLUSIVE REMEDY FOR BREACH OF THE LIMITED WARRANTY CONTAINED HEREIN IS THE REPAIR OR REPLACEMENT OF THE DEFECTIVE PRODUCT BY HISPEC ELECTRICAL PRODUCTS LTD. LIABILITY UNDER ANY OTHER REMEDY PRESCRIBED BY LAW SHALL NOT EXCEED THE PURCHASE PRICE OF THE INDIVIDUAL PRODUCT.

This does not affect your statutory rights.



Waste electrical products should not be disposed of with normal household waste. Please recycle where facilities exist. Check with your local authority or retailer for recycling advice. The new regulation will encourage the recycling of waste from, electrical and electronic equipment (European "WEEE Directive" effective August 2005).

*Warranty Disclaimer - Please note that all lighting equipment must be used in accordance with the instructions provided in this document. Failure to follow these instructions, including but not limited to improper installation, positioning, control, or use of non-recommended accessories, will invalidate the equipment warranty. Always ensure proper safety protocols and the use of certified technicians for setup and operation. \* ON SITE WARRANTY SUBJECT TO CONDITIONS AND UK REGIONS ONLY*